

First Floor

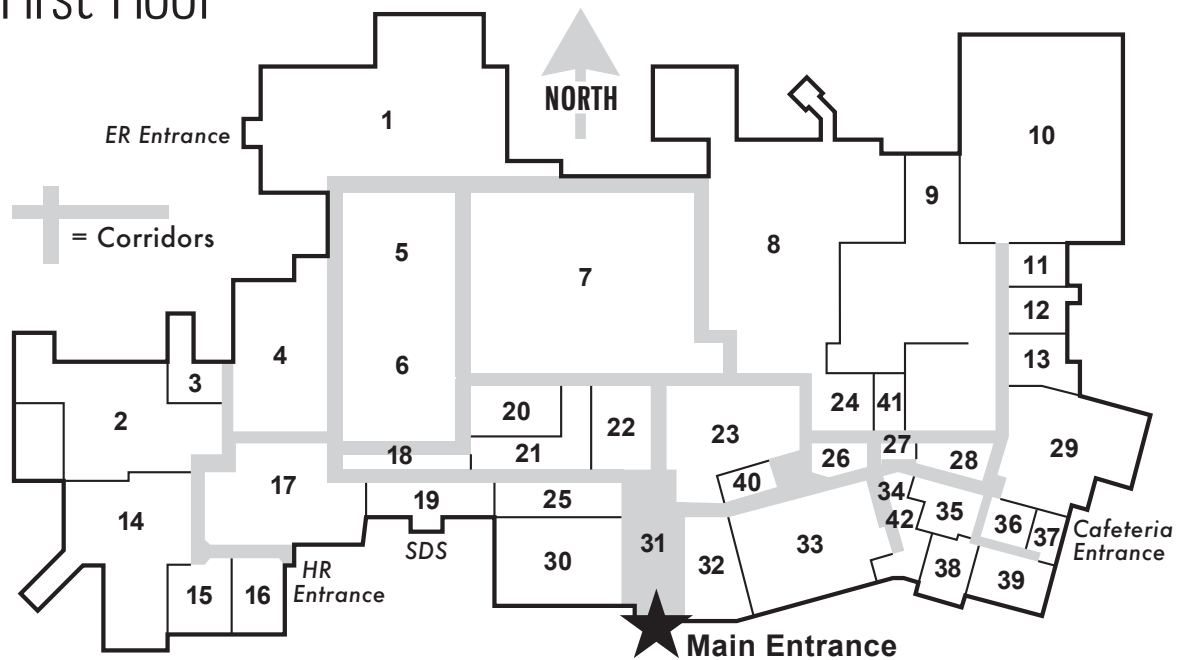

ALPHABETICAL LISTING

42 - Ambulatory Infusion Center-41
 Administration-39
 Behavioral Health Outpatient Services-17
 Bio-Medical-12
 Bradley Room-36
 Business Office-30
 Cafeteria-29
 Cancer Services-2 & 14
 Cardiac Rehab-22
 Cardiopulmonary Department and Outpatient Services-23
 Case Management - 34
 Chapel-18
 Cheyenne Room-34
 Dakota Room-3
 Diagnostic Imaging-8
 Elevators-27
 Emergency Department-1
 Engineering-10
 Environmental Services-13
 Family Waiting Room-20
 Foundation, Strategic Planning, Marketing -28
 Gift Shop-25
 Health Information Management-38
 Human Resources-15
 Laboratory-33
 Laundry-11
 Lobby-31
 Materials Management-9
 Meeting Rooms (Cheyenne, Pawnee, Pioneer, Sioux)- 42

Nebraska Heart Institute-4
 Observation Unit-24
 Patient Resource Center/Medication Assistance Program-40
 Pawnee Room-34
 Pharmacy-32
 Physician Recruitment-37
 Pioneer Room-34
 Quality Management-35
 Same Day Services Admissions -21
 Same Day Services Post-Surgery-5
 Same Day Services Pre-Surgery-6
 Same Day Services Waiting Area-19
 Sioux Room-34
 Sleep Lab-16
 Surgery Suites-7
 Volunteer Services, Employee Health, Infection Control-26

BY NUMBER

1- Emergency Department
 2- Cancer Services
 3- Dakota Room
 4- Nebraska Heart Institute
 5- Same Day Services Post-Surgery
 6- Same Day Services Pre-Surgery
 7- Surgery Suites
 8- Diagnostic Imaging
 9- Materials Management
 10-Engineering
 11- Laundry
 12-Bio-Medical
 13-Environmental Services

14- Cancer Services
 15- Human Resources
 16- Sleep Lab
 17- Behavioral Health Outpatient Services
 18- Chapel
 19- Same Day Services Waiting Area
 20- Family Waiting Room
 21- Same Day Services Admissions
 22- Cardiac Rehab
 23- Cardiopulmonary Department and Outpatient Services
 24- Observation Unit
 25- Gift Shop
 26- Volunteer Services, Employee Health, Infection Control, Utilization Review
 27- Elevators
 28- Foundation, Strategic Planning, Marketing
 29- Cafeteria
 30- Business Office
 31- Lobby
 32- Pharmacy
 33- Laboratory
 34- Case Management
 35- Quality Management
 36- Bradley Room
 37- Physician Recruitment
 38- Health Information Management
 39- Administration
 40- Patient Resource Center/Medication Assistance Program
 41- Ambulatory Infusion Center
 42- Meeting Rooms (Cheyenne, Pawnee, Pioneer, Sioux)